

# Beltpack

User Guide



FCC ID : 2ANZJDEDPS1  
IC : 23304-DEDPS1



DE-DPS Beltpack

Version 15-05-2019

# TABLE OF CONTENTS

## 1 - DESCRIPTION OF THE Beltpack

## 2 - HOW TO...

- 2 - 1 ...Turn on the Beltpack
- 2 - 2 ...Unlock the Beltpack
- 2 - 3 ...Modify the Volume
- 2 - 4 ...Connect to a Tx-Box
- 2 - 5 ...Connect to a Digitear network
- 2 - 6 ...Change the channel used by the Beltpack
- 2 - 7 ...Pair an In-Ear
- 2 - 8 ...Activate Eco mode
- 2 - 9 ...Change the battery

## 3 - ADVANCED FUNCTIONING OF THE Beltpack

- 3 - 1 Beltpack start up
- 3 - 2 Txboxes menu
- 3 - 3 Wlan menu
- 3 - 4 Lock menu
- 3 - 5 Update menu
  - 3 - 5 - 1 Update
  - 3 - 5 - 2 Talk mode
  - 3 - 5 - 3 Clear PDL
- 3 - 6 Connect IE menu
- 3 - 7 Find IE menu
- 3 - 8 Mic menu
- 3 - 9 Channel menu
- 3 - 10 Low battery display

## 4 - TECHNICAL FEATURES

## 5 - WARRANTY

## 6 - CERTIFICATIONS



User guide available at [www.digitear.eu](http://www.digitear.eu)

1 - DESCRIPTION OF THE Beltpack



① Microphone

② LCD screen

③ '+' Key  
Allows you to navigate within the menus or to increase a level (volume, gain...)

④ 'MIC' Key

⑤ Belt clip

⑥ '-' Key  
Allows you to navigate within the menus or to diminish / a level (volume, gain...).

⑦ 'HOME' Key

⑧ 3.5mm - 4 points JACK

⑨ Battery charge connector

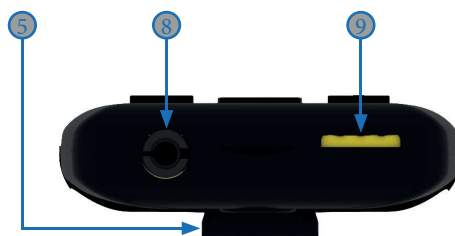

2 - HOW TO...

2 - 1 ...Turn ON the Beltpack

To turn on the Beltpack, press and hold the central key until the Overline Systems logo appears.

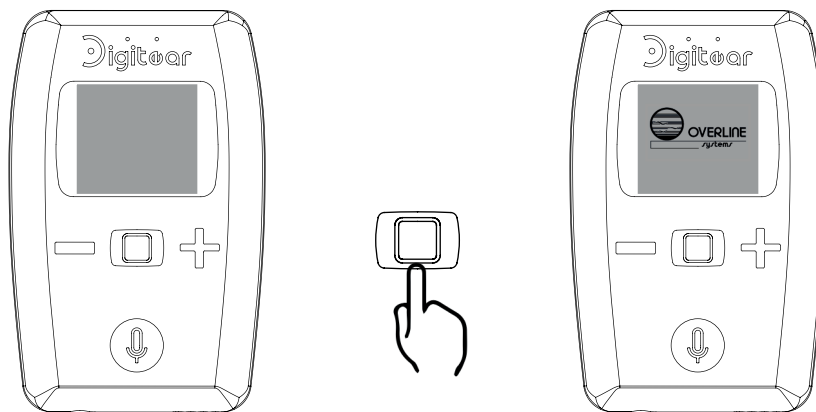

2 - 2 ...Unlock the Beltpack

Press and hold the central key to unlock the Beltpack and to gain access to the menus.

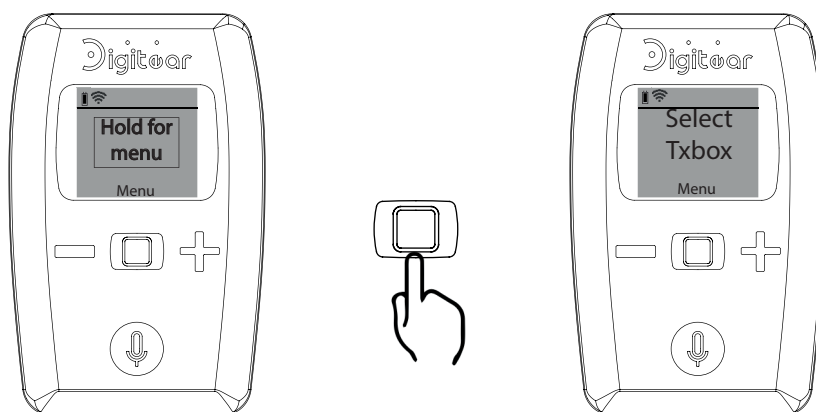

2 - 3 ...Modify the volume

On the main screen, use the + and - keys in order to change the volume. Once the right level is chosen, confirm using the central key.



2 - 4 ...Connect to a Tx-Box

To change or connect to a Tx-Box, press on the menu labeled «TxBoxes»

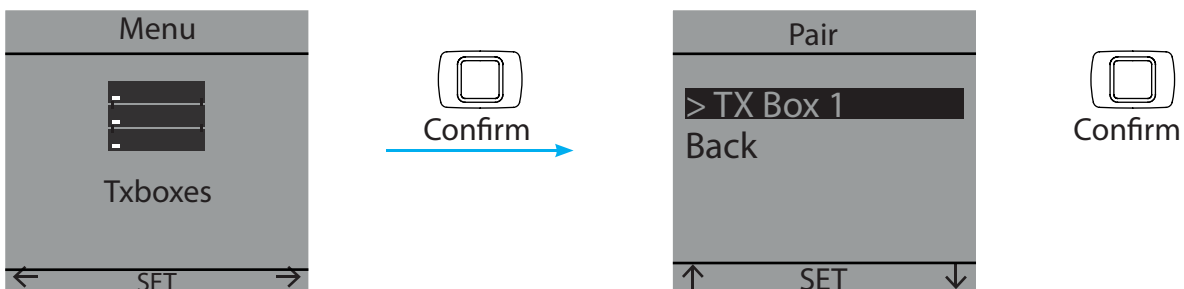

2 - 5 ...Connect to a **Digitear** network

To change or to connect to a **Digitear** network, click on the menu labeled «Wlan». If there is more than one accessible network, the screen will display all the possible choices.

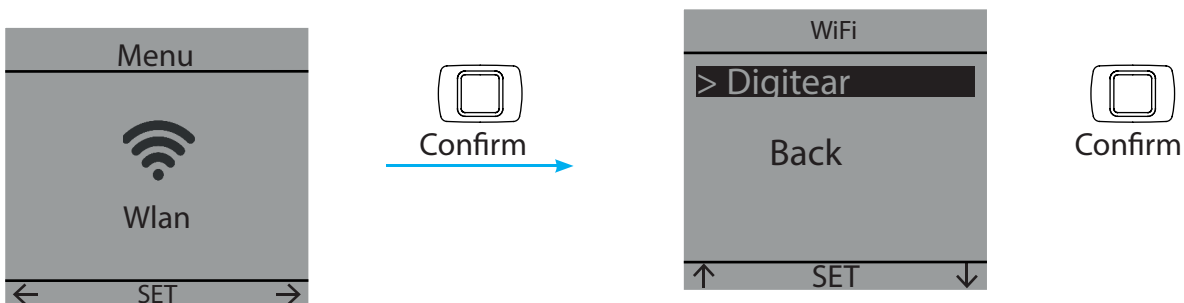

2 - 6 ...Change the channel used by the Beltpack

From the Beltpack, you can change the channel on which the TX-Box was associated to by default during the initial connection.

To do this you must access the «Channel» menu.

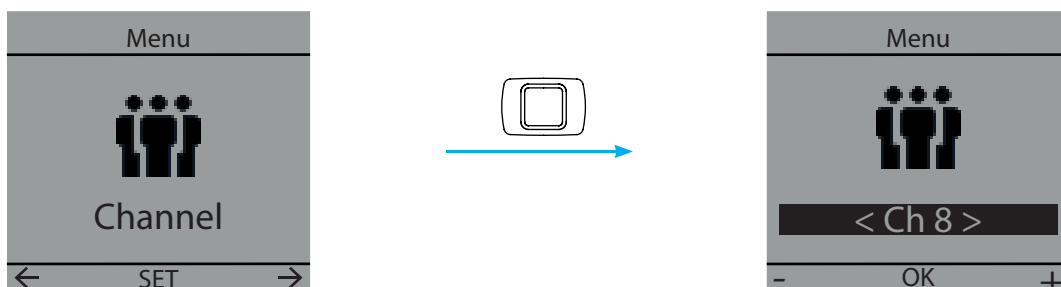

2 - 7 ...Pair a In-Ear

To pair a In-Ear to the Beltpack, you need to go into the «Connect IE» menu.

Once you confirm this choice the Beltpack will connect itself to the nearest In-Ear.

Note :

- The In-Ear needs to be in «discoverable» mode (See In-Ear User Manual).
- The Beltpack can transmit an audio stream to two In-Ears at a time. The two In-Ears must be paired during their first use. This will be done automatically (See In-Ear User Manual).

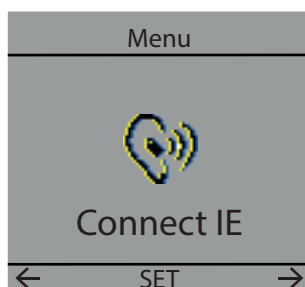

2 - 8 ...Activate Eco mode

Eco mode allows the optimization of the In-Ear battery's life.

The principle is to stop the stream between the In-Ear and the Beltpack when no signals are transmitted from the Beltpacks. A calibration of the noise threshold is done automatically at each activation of the Eco mode.

The key «Calibrate» allows you to redo a new calibration.

You must perform the calibration during a ambient silence, or else you will have to redo the calibration procedure.

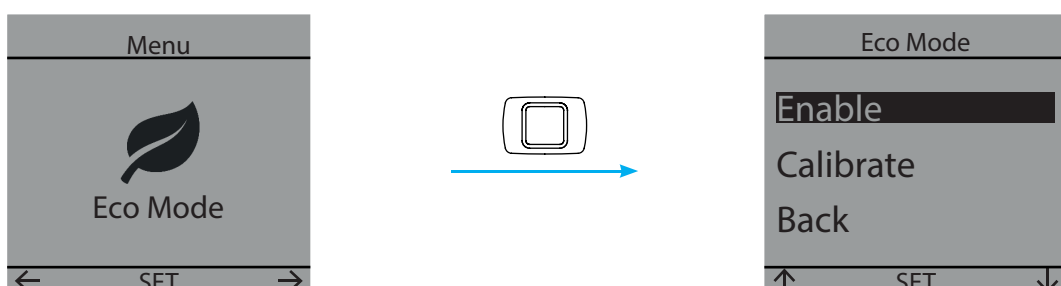

2 - 9 ...Change the battery

A spare battery is provided with the Beltpack.  
To change it you must open the Beltpack's rear cover.  
Only this provided battery type must be used.

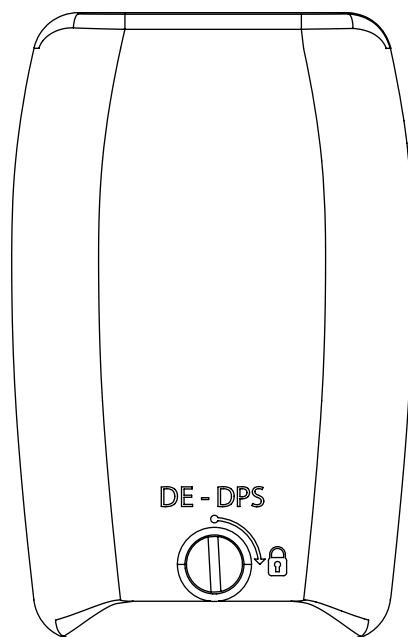

Battery : Li-ion, BL-5C

### 3 - ADVANCED FUNCTIONNING OF THE Beltpack

#### 3 - 1 Beltpack start up

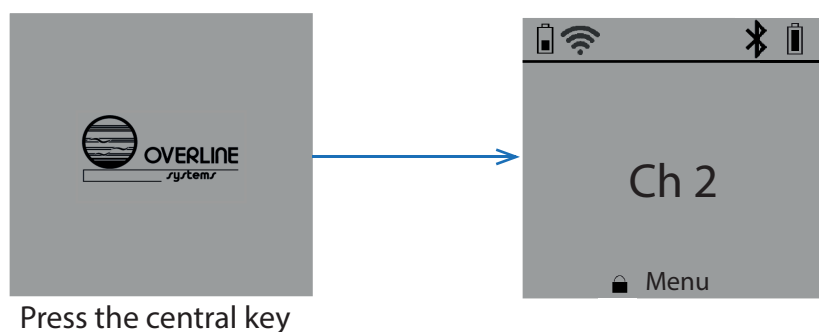

The status bar may be different following the connection state and status.

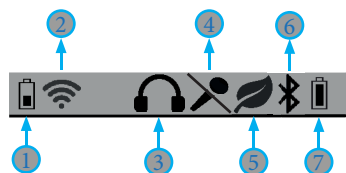

- ① Beltpack's battery level.
- ② Strength of **Digitear** network signal. If the sign  is empty the Beltpack is not connected to any network.
- ③ A headset is connected to the 3.5mm Jack.
- ④ The internal microphone is off:  
The configuration of the «Latency Mode» does not permit the use of the Beltpack's microphone.  
(See User guide of the Tx-Box)
- ⑤ Eco Mode is ON, it will replace the bluetooth sign.
- ⑥ A In-Ear is connected.
- ⑦ The connected In-Ear's battery level.

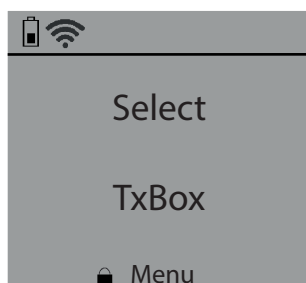

The Beltpack is connected to a **Digitear** network, but is not connected to a TX-Box.

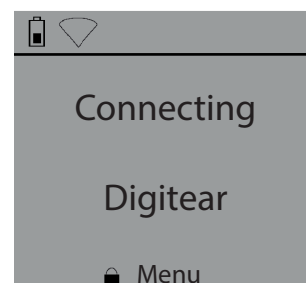

The Beltpack is not connected to a **Digitear** network.



3 - 2 Txboxes menu

Review of the possible actions in the «TxBoxes» menu.

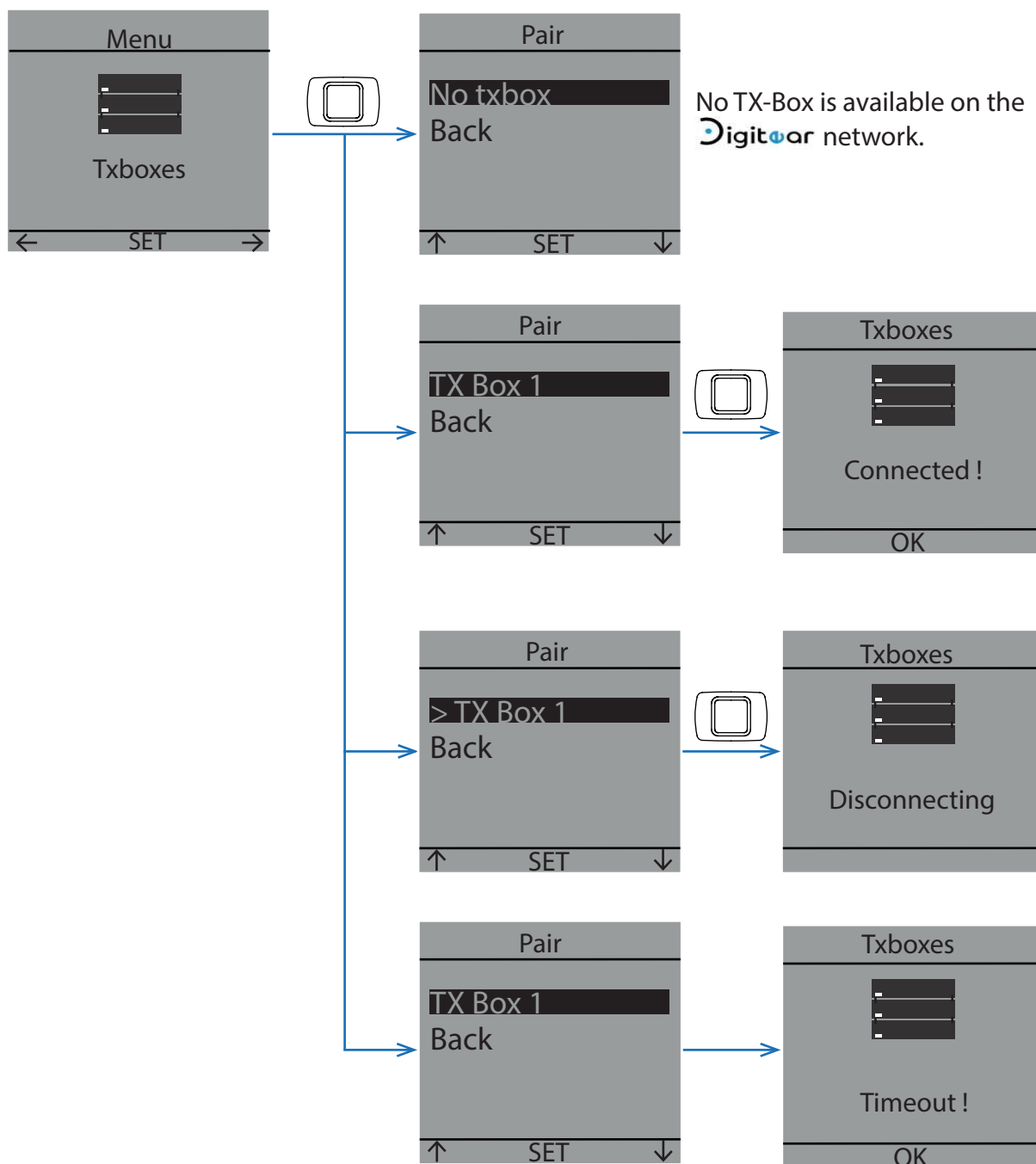

If «Timeout» appears :

- Check the Digitear network.
- Check the configuration of the TX-Box.

3 - 3 Wlan menu

Review of the possible actions in the «Wlan» menu.

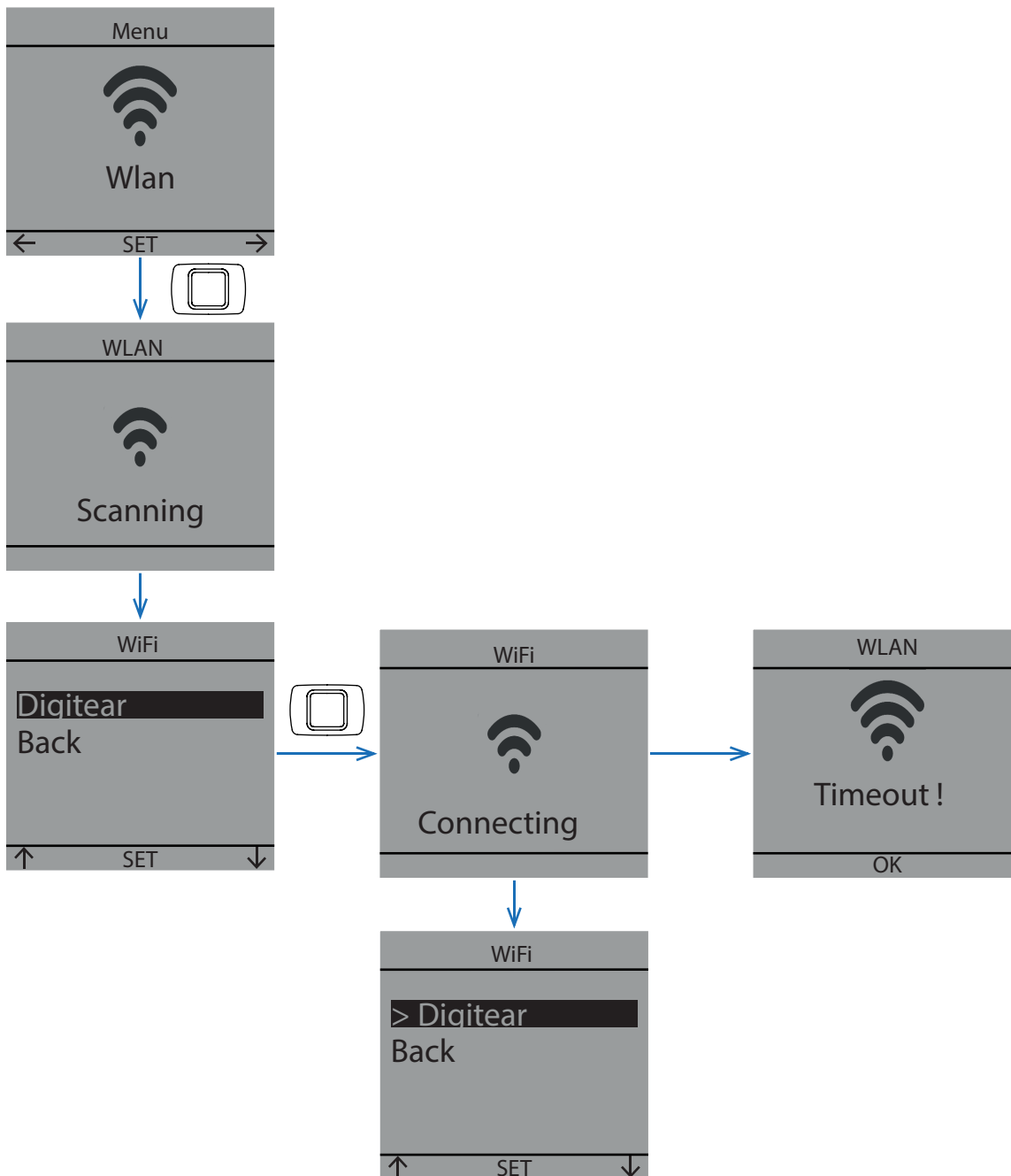

if «Timeout» appears :

- Check the **Digitear** network.
- Check the ACCESS POINT configuration.

3 - 4 Lock menu

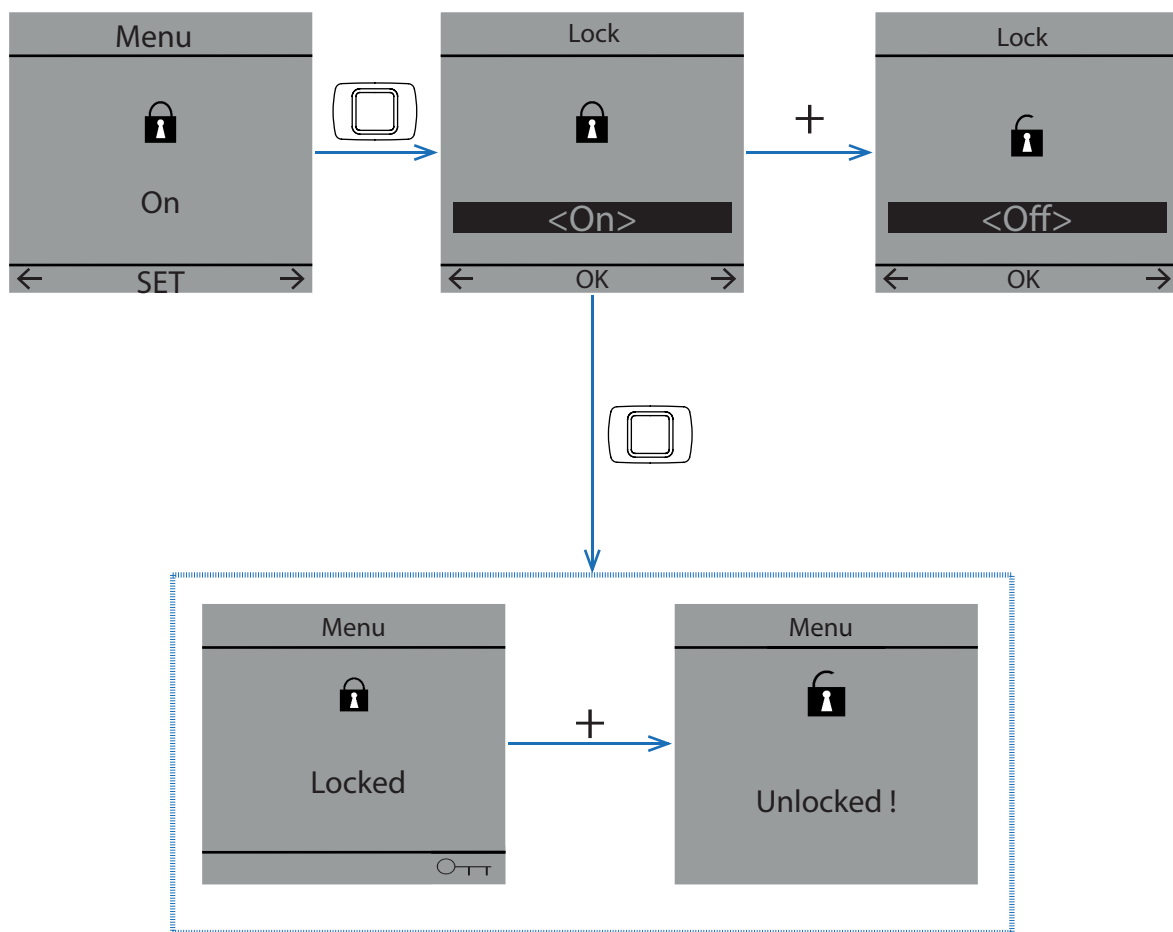

Two different ways to unlock the Beltpack:

- Off: Pressing and holding the central key will give direct access to the menus.
- On: Pressing and holding the central key and validating with the + key will give access to the menus.

3 - 5 Menu Advanced

3 - 5 - 1 Update

This menu gives the user the possibility to update the Beltpack's software. The Beltpack will see the update after it is extracted from the USB drive on the TX-Box. (See User manual of the TX-Box)

At the end of the update, the Beltpack will restart.

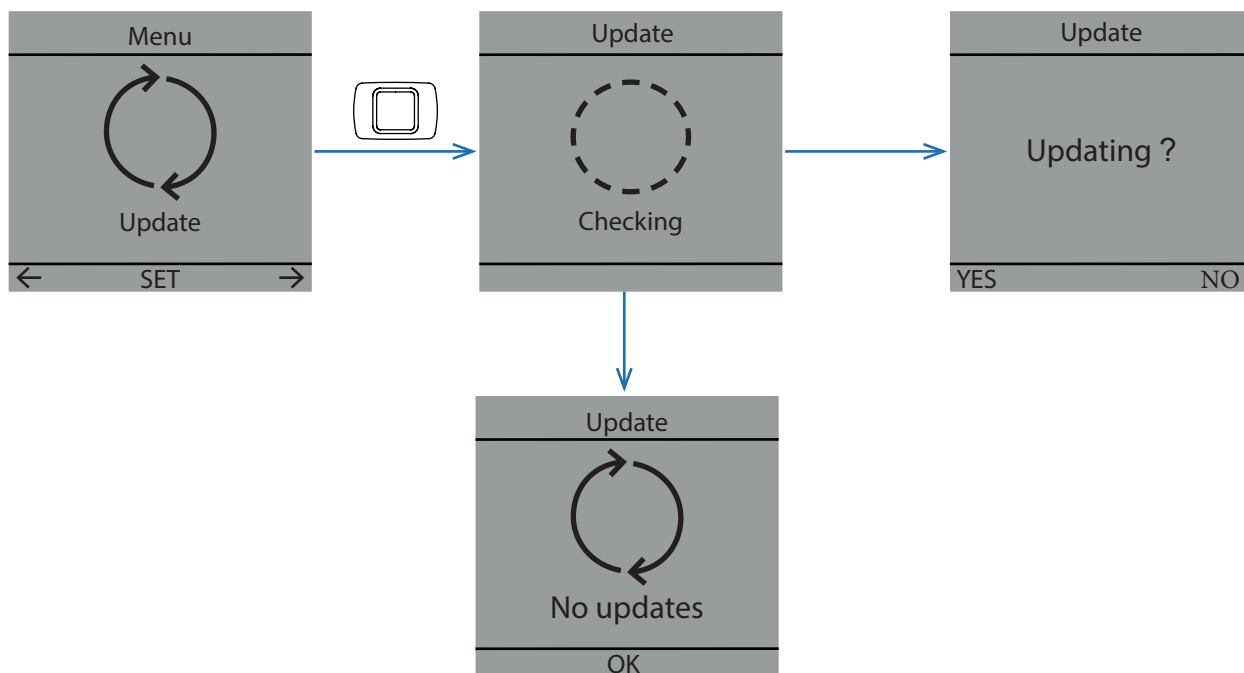

3 - 5 - 2 Talk mode

This menu gives the user the possibility to choose between the different operating modes of the Talk button.

- a - Push (press and hold the Talk button, the microphone is on, the user speaks. Release the Talk button, the microphone is off, the user cannot speak).
- b - Latch (press the Talk button once, the microphone stays on continuously, the user can speak without another action needed on the Talk button. Press the Talk button again, the microphone is off, the user can no longer speak).
- c - Dual (combination of the preceding two modes).

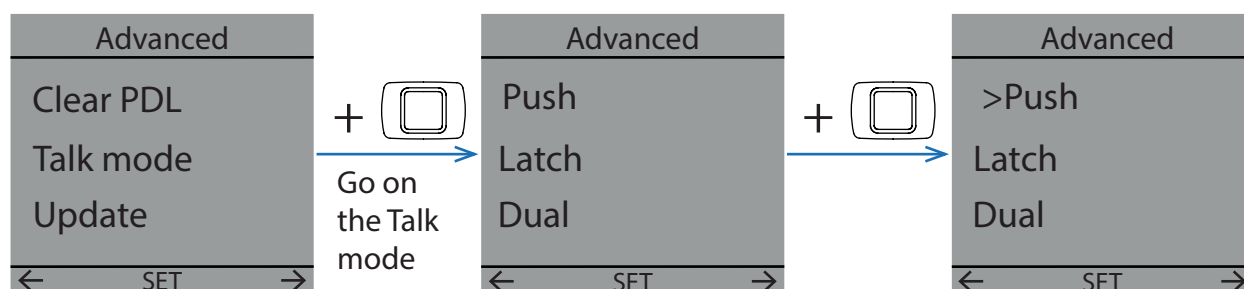

In this example, the «push» mode is activated. Press on the Talk button to return to the main screen.

3 - 5 - 3 Clear PDL

This option allows you to erase and forget the devices associated to the Beltpack. (MAX 7 Earpieces)

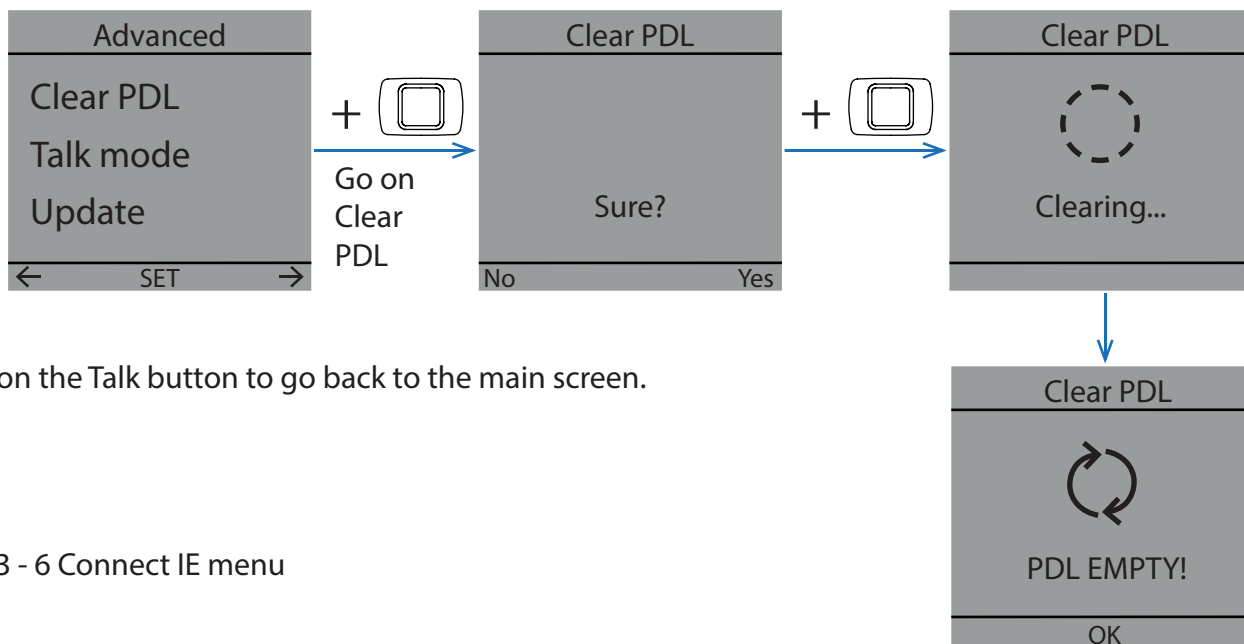

Press on the Talk button to go back to the main screen.

3 - 6 Connect IE menu

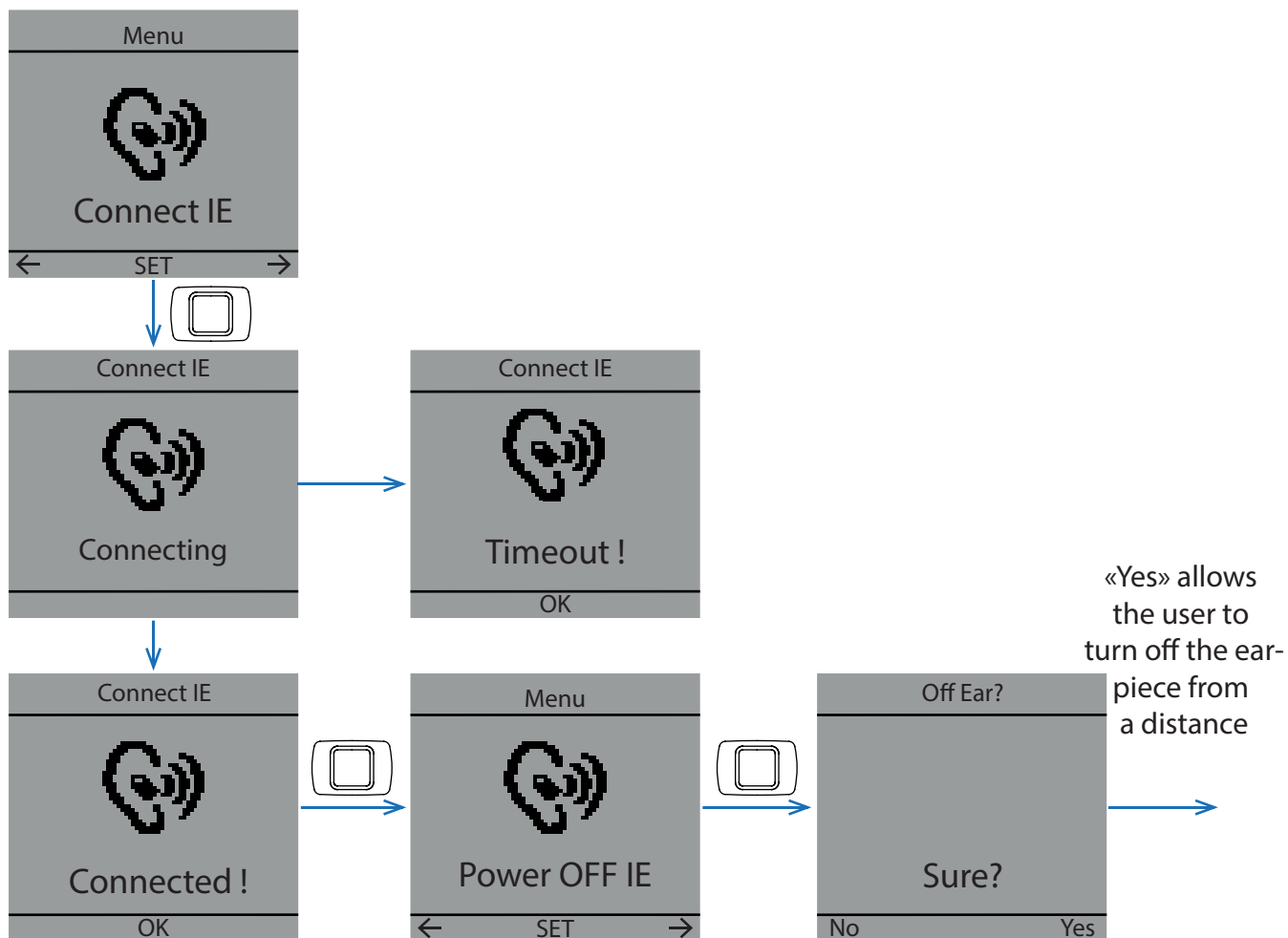

If «Timeout» appears:

- Check that the In-Ear you wish to pair is in «connectable» mode.
- Empty the Beltpack's storage in order to have space for the In-Ear. (Clear PDL Menu)
- Check that the In-Ear is not charging, an In-Ear that is charging cannot be paired (See In-Ear User Guide).
- If it just got disconnected, wait 10 seconds before attempting a new connection.

3 - 7 Find IE menu

This menu gives the user the possibility to search for the In-Ear that is connected to the Beltpack. The In-Ear's light will flash for 10 seconds.

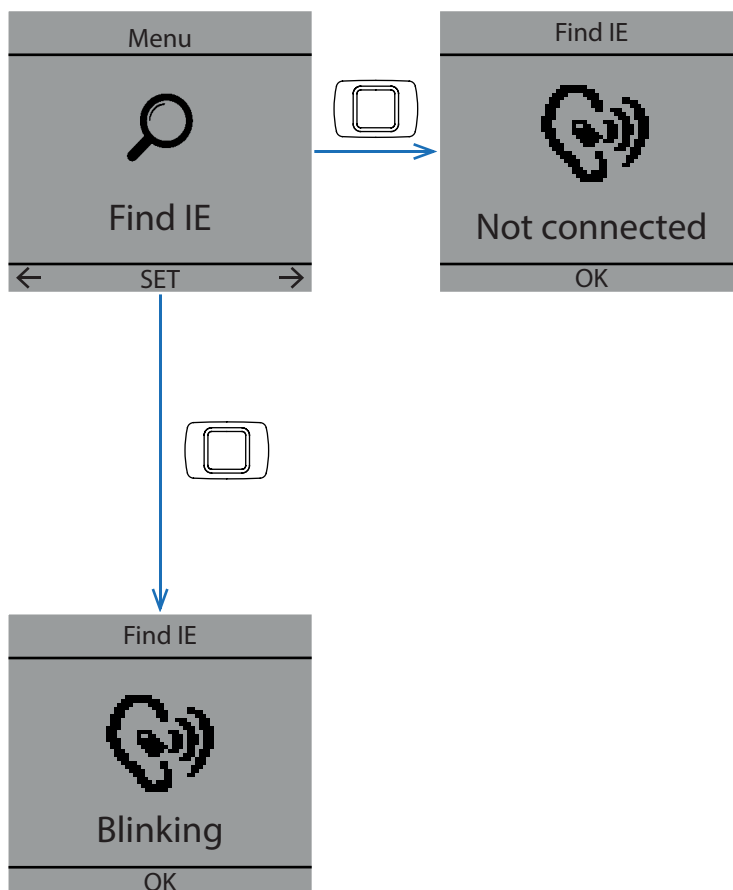

3 - 8 Mic menu

This menu gives the user the possibility to search for the In-Ear that is connected to the Beltpack. The In-Ear's light will flash for 10 seconds.

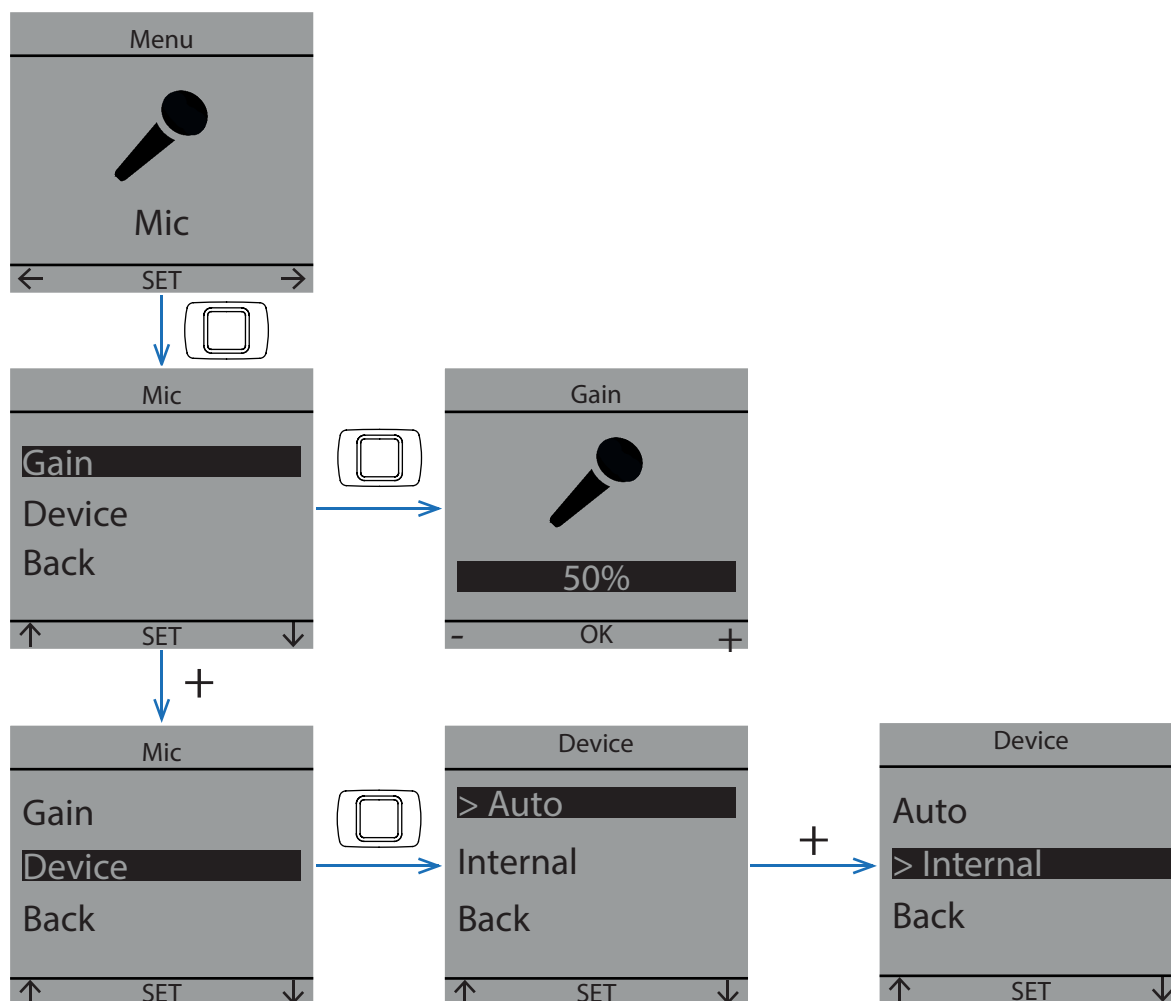

**> Auto** With this option the Beltpack will go from the internal microphone to the external microphone when the user connects a microphone on the 3.5mm Jack.

**> Internal** With this option the Beltpack will not go onto the external microphone when the user connects a microphone on the 3.5mm Jack.

3 - 9 Channel menu

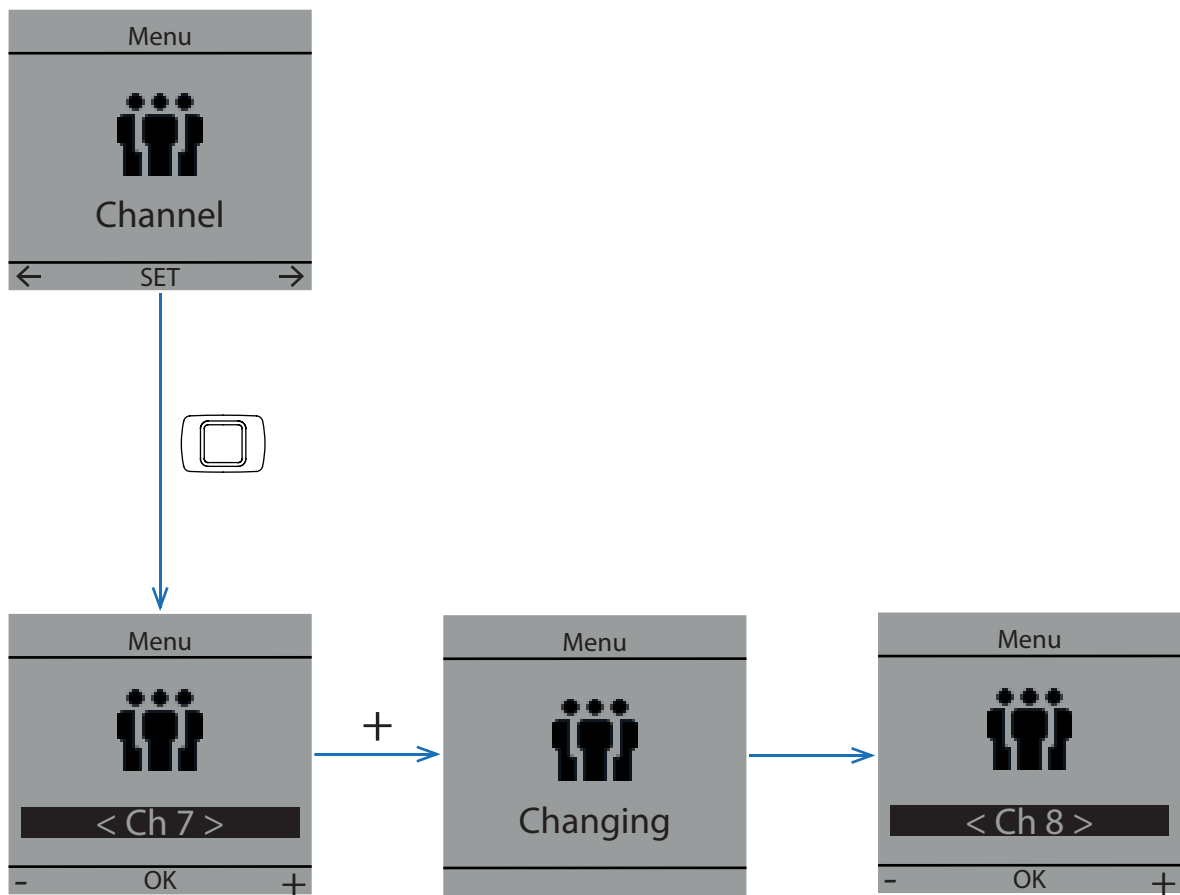

3 - 10 Low battery display

When the Beltpack's battery level becomes very low, it lets you know with this display. From then on you have less than 5 minutes of usage left.





## 4 - TECHNICAL FEATURES

### Bluetooth

Version	Bluetooth 4.2
Class	2
Frequency range	2 400 MHz - 2 483 MHz
Functioning distance	<10 meters

### WiFi

Standard	802.11n
Frequencies	5 GHz

Version CE :  
5180MHz, 5200MHz, 5220MHz, 5240MHz

Version FCC/IC :  
5745MHz, 5765MHz, 5785MHz, 5805 MHz, 5825MHz

### Battery

Type	Lithium - Ion, BL-5C
Autonomy	~6 h
Complete charge	~3 h
Rated capacity	1200 mAh (4,4 Wh)
Nominal voltage (DC)	3,7 V
Operating voltage (DC)	3,3 V et 4,2V
Terms of use	+5 à +45°C
Recommended Accessories	Sennheiser CX275s

### Materials

Type	ABS-PC
Weight	60g with battery
Height	(13x53x93)mm
Terms of use	+5 °C to +45°C

## 5 - WARRANTY

### Elements NOT covered by the warranty

This warranty only covers faulty parts and the manufacturing of the product. This warranty does not cover:

- Periodical maintenance and reparations or replacements of parts due to normal wear and tear
- Shipping and handling costs and the risks associated with the transportation and the retrieval of the product by the final customer
- All adaptations of the product which would be necessary to make it comply with the technical and/or security standards in a country other than the one for which the product was originally designed and manufactured for
- Consumable elements: elements that are scheduled to be replaced periodically during the life of the equipment ( for example: ear tips, batteries over 12 months after the purchase date, and connection cables)

The deteriorations or defects of the product resulting in:

- A poor usage or installation of the product ( for example: using the product in a way not intended, installation or usage not standard to **Digitear**'s instructions and to the technical standards or security in the country where it is used)
- Maintenance of the product non-compliant to Overline Systems' instructions or negligence in maintenance of the product
- Any mishandling of the product (ex: false manoeuvre, fall, shock, impact, immersion ) or an inappropriate environment (ex: bad aeration, vibrations, exposure to humidity or excessive heat, contacts with a product (material or software), consumable, accessory or device non compatible or defective, an adaptation of the product towards its end of being put to conformity with technical or security standards in a country other than the one the product was originally designed and manufactured for
- A modification or a reparation of a product not made by a third party approved by Overline Systems
- Sinister (ex: fire, flood, earthquake, lightning)

Produit: **Digitear** (TX-Box, Charger Box, Beltpack, In-Ear)

24 months pieces or workshop labor

Battery: 12 months (starting the purchase date)

ACCESS POINT: covered by the manufacturer's initial warranty

Accessories alone will not be taken in by our reparation centers.

## 6 - CERTIFICATIONS

Produit destiné à une utilisation en intérieur.

This product is recommended for indoor use only.

Tout changement ou modification apporté à cet équipement non expressément approuvé par OVERLINE Systems peut annuler l'autorisation d'utiliser cet équipement.

Any changes or modifications made to this equipment not expressly approved by OVERLINE Systems may void the authorization to operate this equipment.

Dans la bande de fréquences 5150-5250MHz, les WAS/RLAN sont limités à une utilisation intérieure des bâtiments.

Operations in the 5,15 - 5,25GHz band are restricted to indoor usage only.

Item (HVIN) : DE-DPS BELTPACK

Type identification : DE-DPS-001

PMN : Digitear

Version EUROPE

CE

L'équipement est conforme aux exigences suivantes :

This product complies to the following requirements :

Radio :

ETSI EN 300328 V2.1.1

ETSI EN 301893 V1.8.1

Compatibilité électromagnétique :

ETSI EN 301 489-1 V2.2.0 (DRAFT)

ESTI EN 301 489-17 V3.2.0 (DRAFT)

Sécurité :

IEC 62368-1: 2014 (2.Edition) and Cor. 1: 2015

EN 62368-1: 2014/AC: 2015/A11: 2017

Exposition RF (DAS) :

EN 50666:2013/AC:2014

EN 62209-2 (2010)

1999/519/EC

DoC disponible sur : [www.digitear.eu](http://www.digitear.eu)

DoC available : [www.digitear.eu](http://www.digitear.eu)

Version FCC/IC

FCC ID : 2ANZJDEDPS1

IC : 23304-DEDPS1

L'équipement est conforme aux exigences suivantes :

This product complies to the following requirements :

47 CFR Part 15  
RSS-247 Issue 2  
RSS-Gen Issue 4

Le présent appareil est conforme aux CNR d'Industrie Canada applicables aux appareils radio exempts de licence. L'exploitation est autorisée aux deux conditions suivantes:

- (1) l'appareil ne doit pas produire de brouillage, et
- (2) l'utilisateur de l'appareil doit accepter tout brouillage radioélectrique subi, même si le brouillage est susceptible d'en compromettre le fonctionnement.

NOTICE : This device complies with Part 15 of the FCC Rules and with Industry Canada licence-exempt RSS standard(s).

Operation is subject to the following two conditions:

- this device may not cause harmful interference, and
- this device must accept any interference received, including interference that may cause undesired operation.

Dans la bande de fréquences 5150-5250MHz, les WAS/RLAN sont limités à une utilisation intérieure des bâtiments.

Operations in the 5,15 - 5,25GHz band are restricted to indoor usage only.

Exposition RF (DAS)

RF exposure :

IEEE 1528-2013

RSS-102 Issue 5

Radiofrequency radiation exposure Information:

This equipment complies with FCC radiation exposure limits set forth for an uncontrolled environment.

This transmitter must not be co-located or operating in conjunction with any other antenna or transmitter.

Radiofrequency radiation exposure Information:

The radiated output power of the device is far below the FCC radio frequency exposure limits.

Nevertheless, the device shall be used in such a manner that the potential for human contact during normal operation is minimized.